

MECHANICAL

ROTOR ASSEMBLY

CHU011002000E08

1. Assemble in the order indicated in the table.

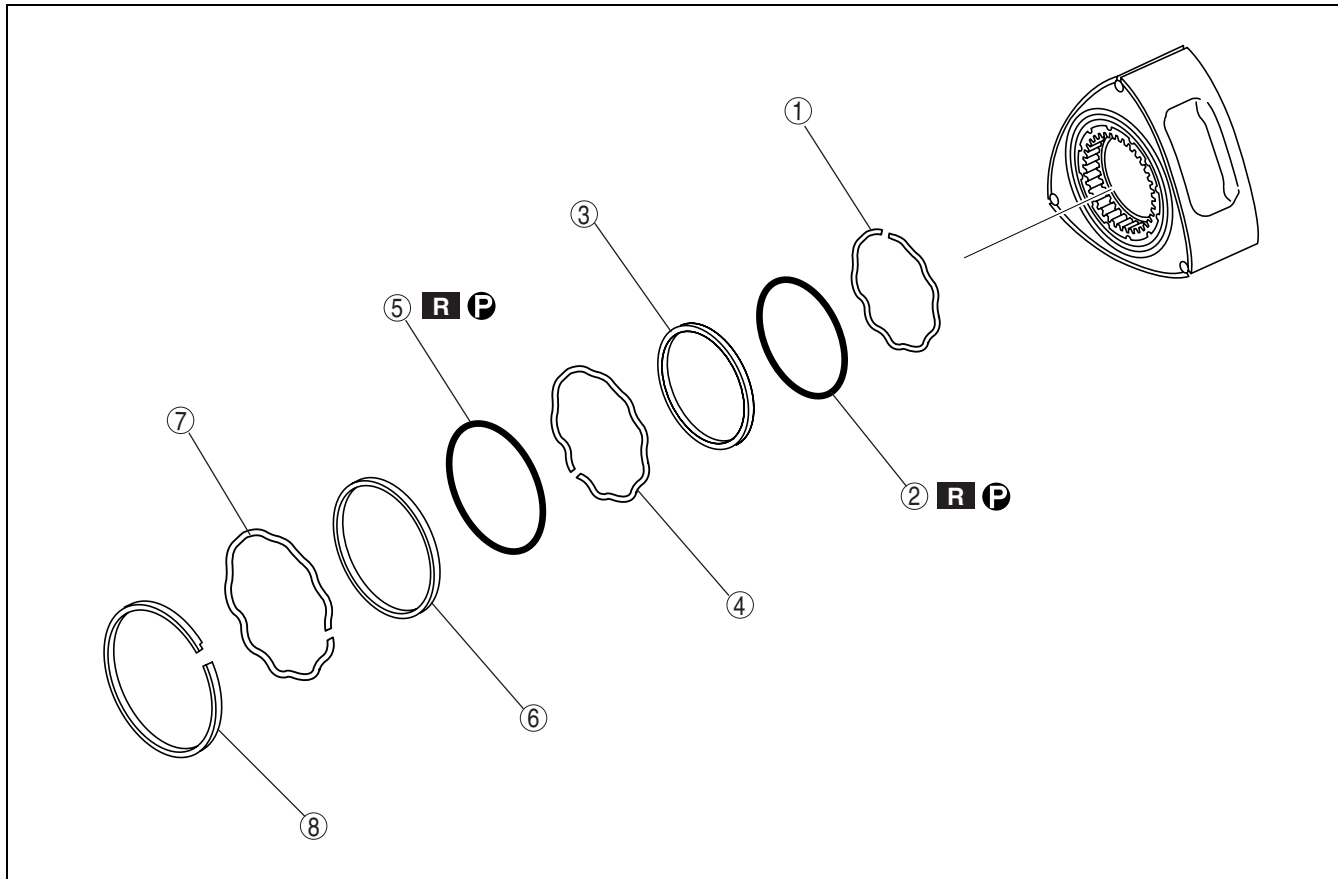

BHJ0110E074

1	Inner oil seal spring (See 01-10-30 Oil Seal Spring Assembly Note.)
2	Inner O-ring (small radius) (See 01-10-31 O-Ring Assembly Note.)
3	Inner oil seal (See 01-10-32 Oil Seal Assembly Note.)
4	Outer oil seal spring (See 01-10-30 Oil Seal Spring Assembly Note.)

5	Outer O-ring (large radius) (See 01-10-31 O-Ring Assembly Note.)
6	Outer oil seal (See 01-10-32 Oil Seal Assembly Note.)
7	Cut-off seal spring (See 01-10-32 Cut-Off Seal Spring Assembly Note.)
8	Cut-off seal (See 01-10-33 Cut-Off Seal Assembly Note.)

Oil Seal Spring Assembly Note

1. Assemble the oil seal spring with the identification color upward.

Spring Identification Color

Rotor	Front rotor		Rear rotor	
	Engine front side	Engine rear side	Engine front side	Engine rear side
Inner	White	Blue	White	Blue
Outer	White + pink	Blue + pink	White + pink	Blue + pink

Caution

- It is possible that the identification color may not be visible when reusing the oil spring. In that case, assemble the rounded end towards the rotor side and the squared end upward.
- Be careful when assembling the oil seal spring of the front and rear rotor since each spring of the engine front side and engine rear side are the same.

Note

- Either one of the two rotation lock slots on the oil seal can be used as a reference.

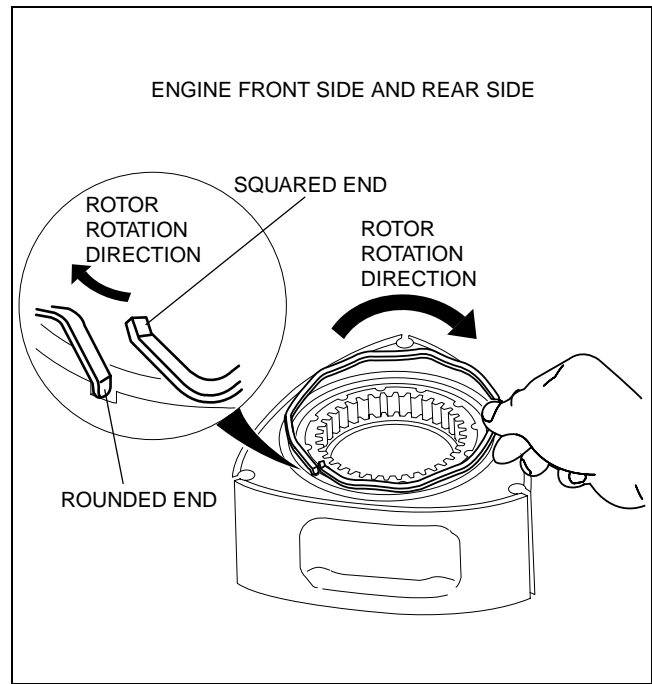

- Assemble the rounded end within **0—15 mm {0—0.59 in}** away from the oil seal spring rotation lock.

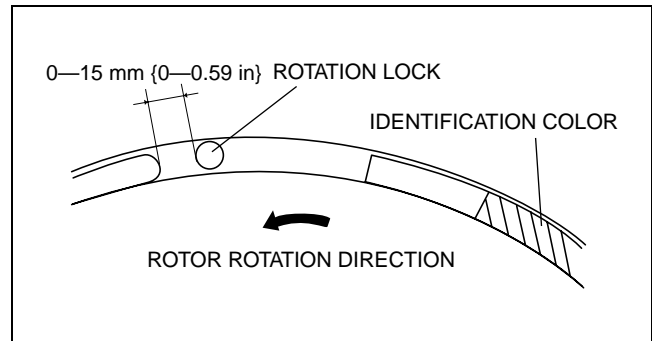

O-Ring Assembly Note

1. Apply petroleum jelly to a new O-ring.
2. Assemble the O-ring to the oil seal.

Note

- Assemble the thicker O-ring to the inner oil seal (small radius), and the thinner O-ring to the outer oil seal (large radius).

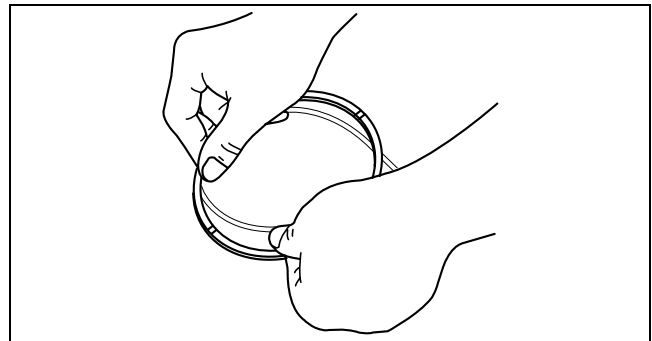

MECHANICAL

Oil Seal Assembly Note

1. Temporarily install the oil seal with the squared end of the oil seal spring fit into the slot of the oil seal.

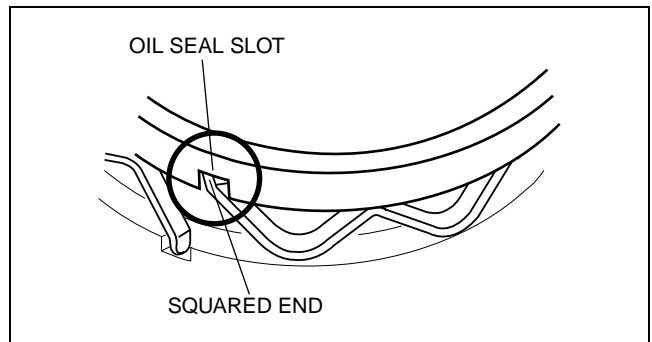

CHU0110E026

2. Push in the oil seal using an old oil seal.
3. Verify that the stroke of the oil seal is smooth and there is no catching by pushing the oil seal with your hand.

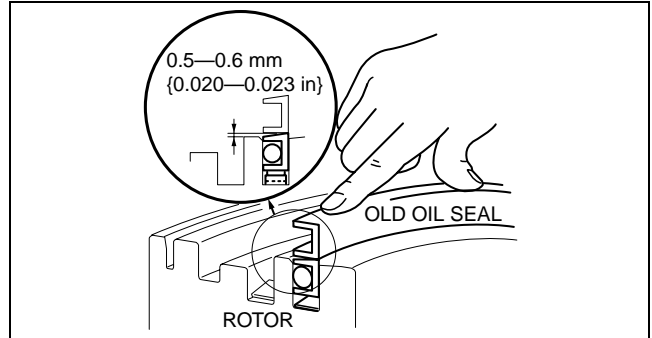

CHU0110E027

Cut-Off Seal Spring Assembly Note

1. Assemble the cut-off seal spring with the spring end turned upward.

Note

- When replacing a cut-off seal with a new one, assemble the seal with the pink surface facing upward.

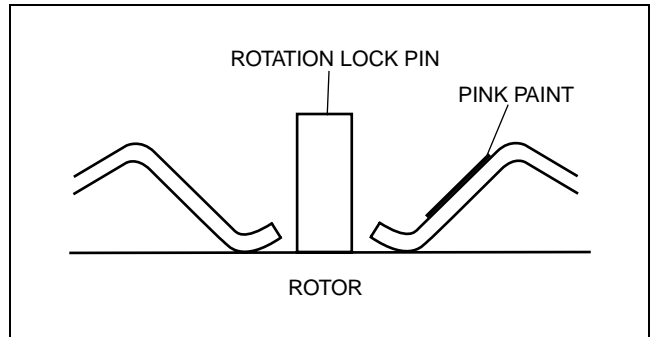

CHU0110E028

MECHANICAL

Cut-Off Seal Assembly Note

1. Assemble the cut-off seal so that it does not run over the rotation lock pin.

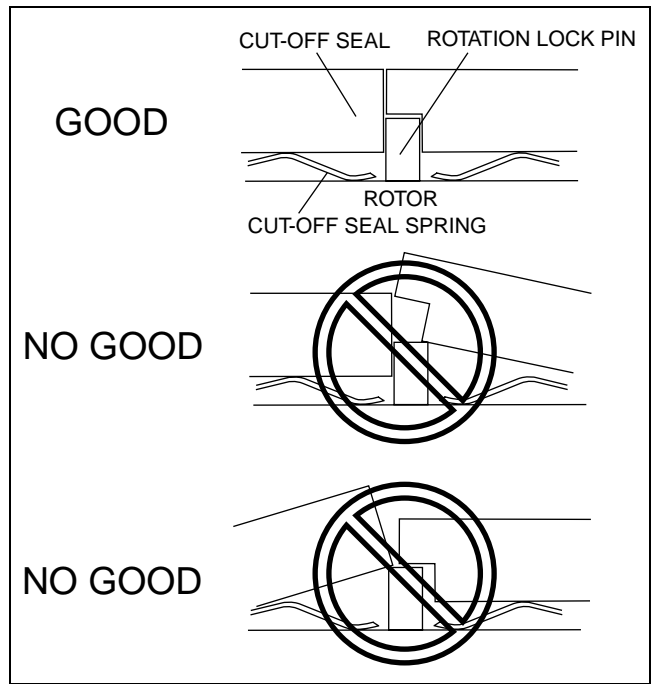

CHU0110E029

01-10